



Big Capacity Mining Mixer Blender Tank For Copper, Fe, Cr Ore

Our Product Introduction

for more products please visit us on mining-crushermachine.com

Basic Information

- Place of Origin: China
- Brand Name: Ascend
- Certification: CE/ISSO9001
- Model Number: MX1000 MX1200 MX1500
- Minimum Order Quantity: 1 set
- Price: USD 3500-30000 Per set
- Packaging Details: Water and rust proof in wooden box or cotainer
- Delivery Time: 7-10 working days
- Payment Terms: T/T, Western Union, MoneyGram
- Supply Ability: 10 set per month



Product Specification

- Certification: CE,ISO9001
- Condition: New
- Dimension(l*w*h): Depend,1215x860x1415mm
- Capacity: 0.5 To 3 Ton Per Hour
- Name: Mining Mixer Tank
- Application: Mining Slurry Mixing Barrel
- Color: Customized
- Applied Ore: Copper, Gold, Chrome
- Highlight: **chrome mining mixer tank, Cr Ore Blender Tank**



More Images



Product Description

Gold copper lead mining ore mixer tank agitation mixer machine

Mining mixer tank is used in stirring the pulp before flotation. Powered by the motor through wedge shaped belts, the impeller rotates, so that the pulp in the barrel can be blended completely with the flotation reagent. This creates premise for mineral processing. Mineral mixer is also applied to the agitation of nonmetallic materials.



Working principle

Application range :It is widely used in the mixing of various metal ore and non-metal minerals, and the concentration is not more than 30% (by weight) of pulp with a particle size of less than 1 mm. It can also be used in industrial sectors such as slurry mixing and sewage treatment plants in the chemical and building materials industries.

- | | |
|---------------------|------------------------|
| 1. 电机 Motor | 6. 皮带 Belt |
| 2. 电机座 Motor Seat | 7. 支架 Stand |
| 3. 轴承座 Bearing Seat | 8. 搅拌桶 Agitation Plate |
| 4. 电机轮 Motor Wheel | 9. 传动轴 Drive Shaft |
| 5. 皮带轮 Belt Pulley | 10. 叶轮 Impeller |

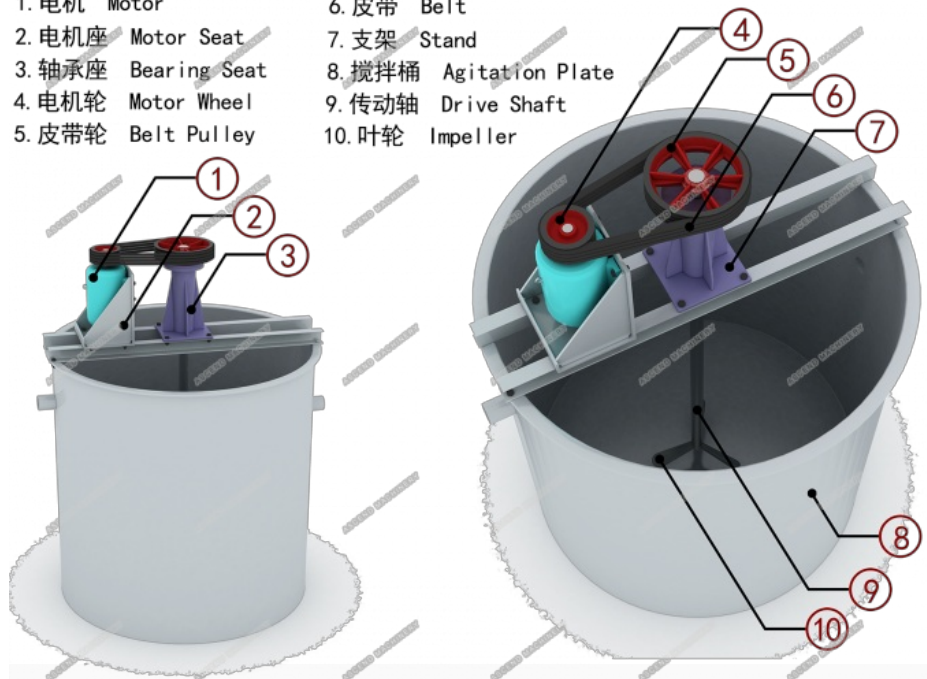

Product advantages

The mixing barrel has compact structure and good sealing performance, and a gray ash plate is arranged at the feeding port to prevent the water mist from collapsing. Stir well, the mixing blade is fan-shaped, and the contact area with the medium is large when stirring. The nozzles are arranged in multiple rows, and the water volume is uniform and adjustable. Advanced performance, stable quality of finished products, uniform mixing and rapid discharge.



Specifications

Model	Volume m3	Impeller		Motor		Weight kg
		Revolutiom rpm	Diameter mm	Model	Power kw	
GBJ-1000×1000	0.58	530	240	Y112M-6	2.2	1548
GBJ-1250×1250	1.4	350	240	Y100L2-4	3	1808
GBJ-1500×1500	2.2	320	420	Y132M2-6	5.5	2207
GBJ-2000×2000	4.4	240	560	Y160L-6	11	3150
GBJ-2500×2500	11.2	271	560	Y180L-6	15	3943
GBJ-3000×3000	19.1	240	700	Y225S-8	18.5	4613
GBJ-4000×4000	37	180	900	Y280S-6	45	9249

ASCEND Henan Ascend Machinery Equipment Co., Ltd.

+86 18221130967

wilson_ascendme@163.com

mining-crushermachine.com

Shenglong block, high tech zone, Zhengzhou, China